

We provide superior
performing compressed air

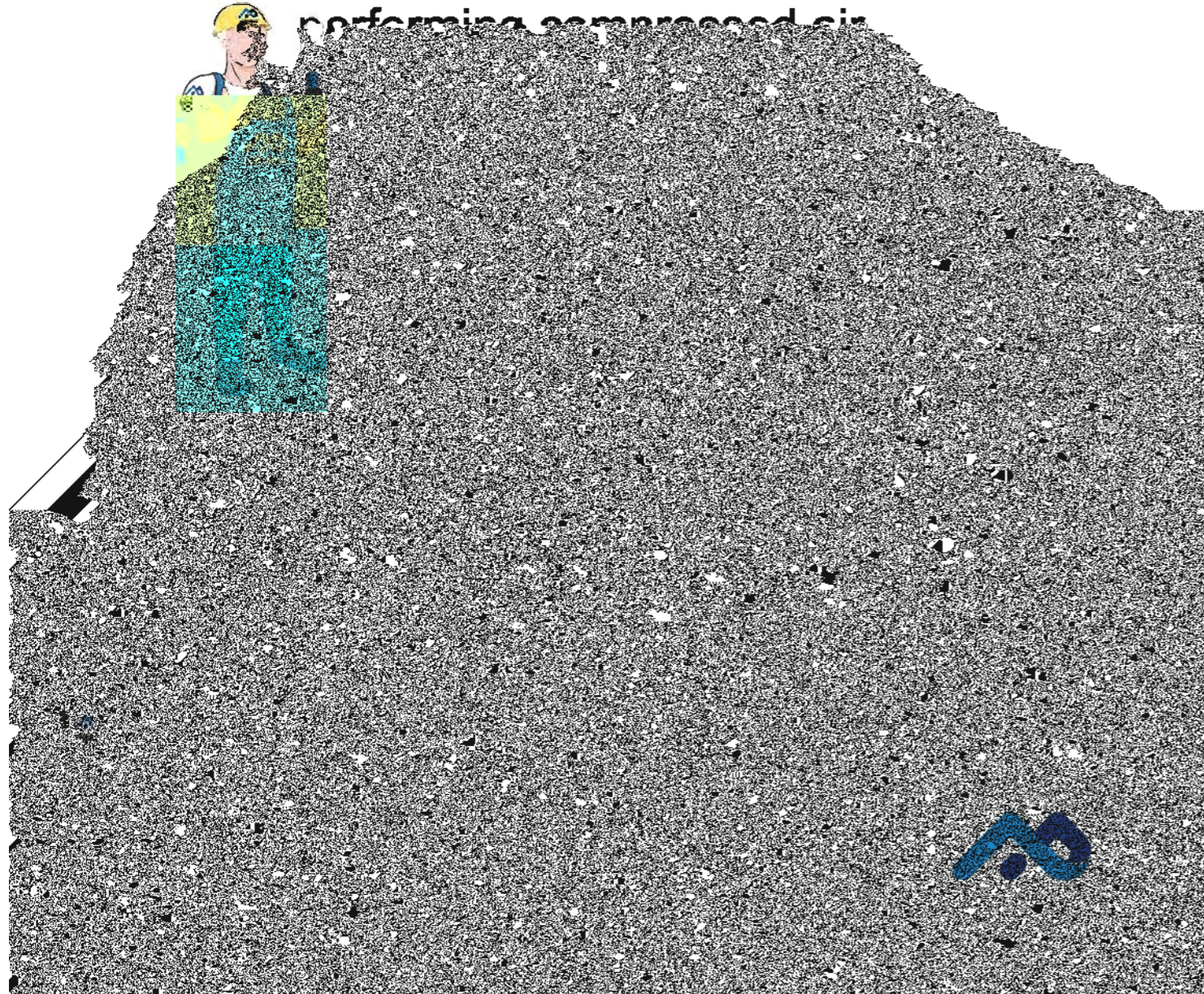

ENGINEERED FOR SUPERIOR PERFORMANCE

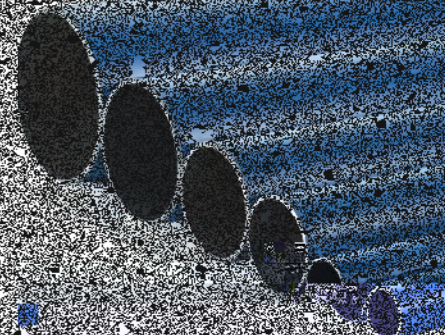

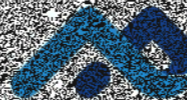
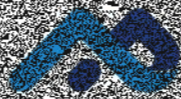
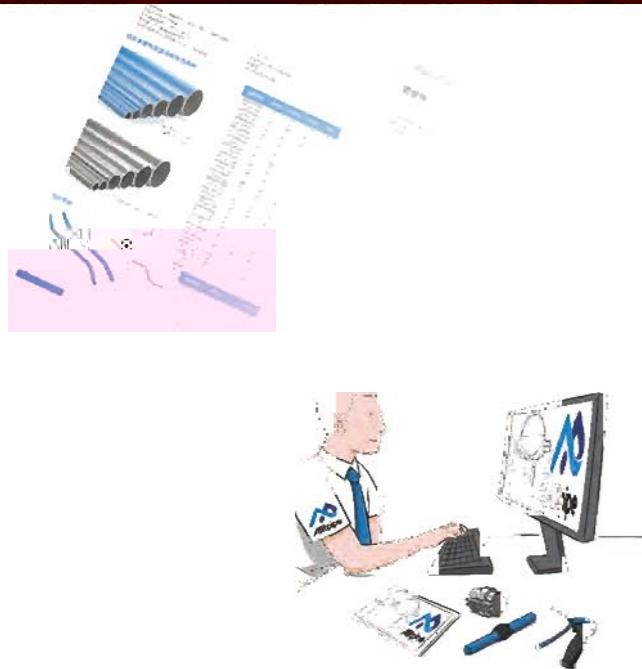
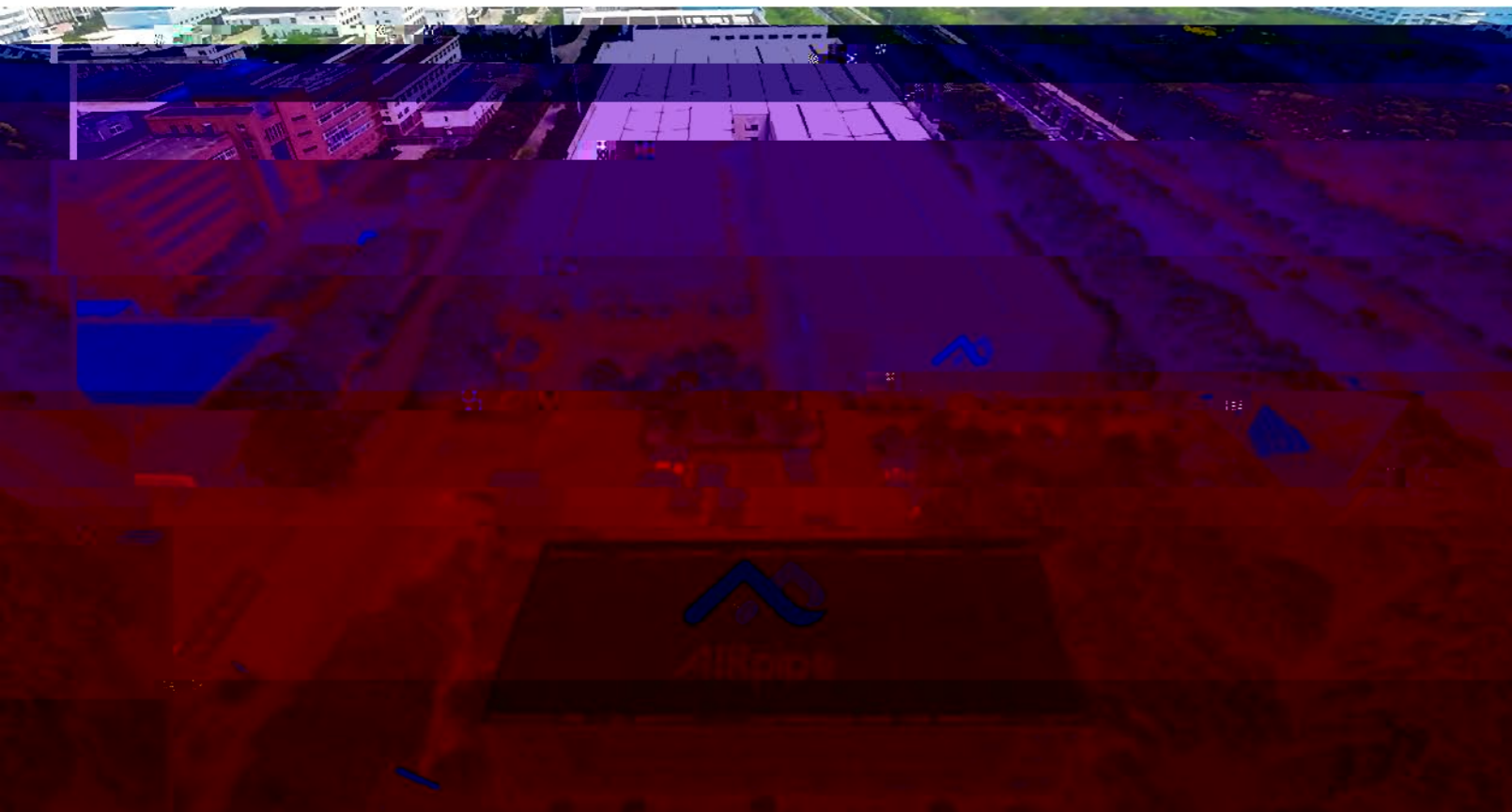

Superior Reliability & Longevity

-
-
-
-



Energy & Cost Savings

-
-

Quick & Easy Modular Installation

-
-
-
-

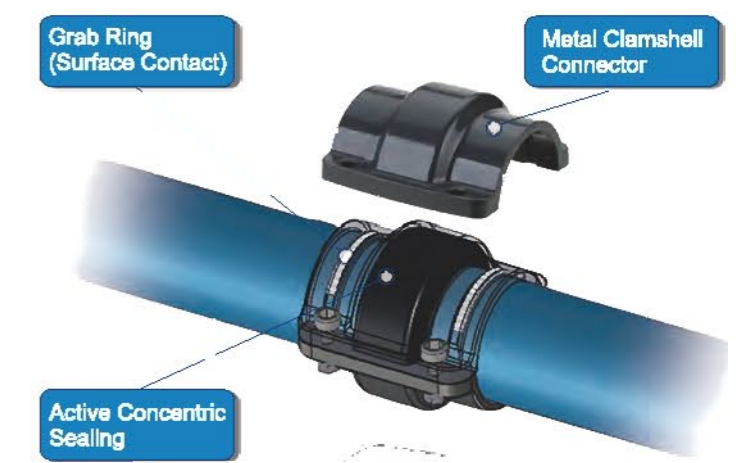

Dual Performance

- Surface contact and active sealing
- Working Pressure up to 16bar
- 20 year life

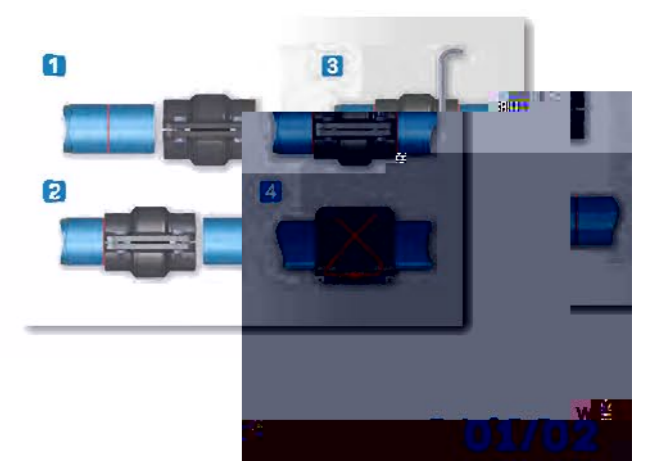
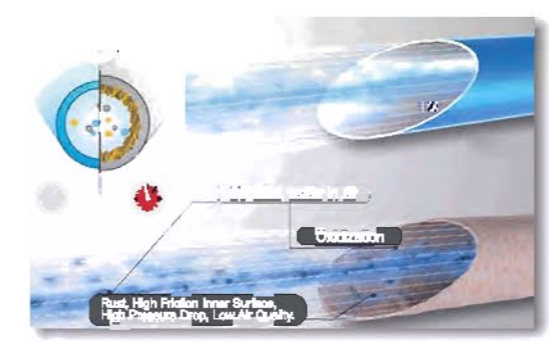

Product Range & Features

Aluminum Pipe



-
-
-
-

Ball & Butterfly Valves



-
-
-
-

Pipe Connectors



-
-
-
-
-

Flexible Hoses



- S
- A
- R
- R

Quick Drop Fittings



-
-
-
-

Tools & Accessories

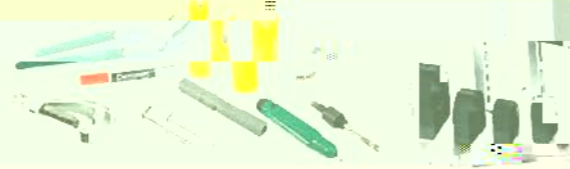

- S
- U
- D

BLUE ALUMINUM PIPE



GREEN ALUMINUM PIPE

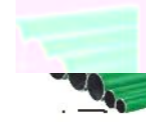

GRAY ALUMINUM PIPE



EQUAL 90° ELBOW



EQUAL 45° ELBOW



END CAP

REDUCING TEE



LATERAL REDUCING TEE



EQUAL PIPE TO PIPE CONNECTORS

EQUAL TEE

REDUCING PIPE TO PIPE CONNECTORS

LATERAL EQUAL TEE

ALUMINUM JOINT FEMALE TREATMENT



**ALUMINUM JOINT
MALE THREAD**

AIRpipe	BSP	DN	Size
302 17 0100 02	20	1/2"	
302 17 0101 02	20	3/4"	
302 17 0200 02	25	1/2"	
302 17 0201 02	25	3/4"	
302 17 0202 02	25	1"	
302 17 0402 02	40	1"	
302 17 0403 02	40	1 1/4"	
302 17 0404 02	40	1 1/2"	
302 17 0405 01	40	2"	
302 17 0504 02	50	1 1/2"	
302 17 0505 02	50	2"	
*Union connector Included			
302 17 0605 01	63	2"	
302 17 0606 01	63	2 1/2"	
302 17 0706 01	80	2 1/2"	
302 17 0707 01	80	3"	
*Use one union connector			

QUICK DROP

**ALUMINUM ELBOW
MALE**

AIRpipe	BSP	DN	Size
302 15 0100 01	20	1/2"	
302 15 0101 01	20	3/4"	
302 15 0200 01	25	1/2"	
302 15 0202 01	25	1"	
302 15 0404 01	40	1 1/4"	
302 15 0505 01	50	2"	
*Union connector Included			
ALUMINUM ELBOW FEMALE			
AIRpipe	BSP	DN	Size
302 13 0100 01	20	1/2"	
302 13 0101 01	20	3/4"	
302 13 0200 01	25	1/2"	
302 13 0202 01	25	1"	
302 13 0404 01	40	1 1/4"	
302 13 0505 01	50	2"	
*Union connector Included			

**QUICK DROP
FEMALE THREAD**

AIRpipe	BSP	DN	Size
302 11 0200 03	25	1/2"	
302 11 0400 03	40	1/2"	
302 11 0401 03	40	3/4"	
302 11 0402 03	40	1"	
302 11 0403 03	40	1 1/4"	
302 11 0404 03	40	1 1/2"	
302 11 0405 03	40	2"	
302 11 0406 03	40	2 1/2"	
302 11 0407 03	40	3"	
302 11 0408 03	40	3 1/2"	
302 11 0409 03	40	4"	
302 11 0410 03	40	4 1/2"	
302 11 0411 03	40	5"	
302 11 0412 03	40	5 1/2"	
302 11 0413 03	40	6"	
302 11 0414 03	40	6 1/2"	
302 11 0415 03	40	7"	
302 11 0416 03	40	7 1/2"	
302 11 0417 03	40	8"	
302 11 0418 03	40	8 1/2"	
302 11 0419 03	40	9"	
302 11 0420 03	40	9 1/2"	
302 11 0421 03	40	10"	
302 11 0422 03	40	10 1/2"	
302 11 0423 03	40	11"	
302 11 0424 03	40	11 1/2"	
302 11 0425 03	40	12"	
302 11 0426 03	40	12 1/2"	
302 11 0427 03	40	13"	
302 11 0428 03	40	13 1/2"	
302 11 0429 03	40	14"	
302 11 0430 03	40	14 1/2"	
302 11 0431 03	40	15"	
302 11 0432 03	40	15 1/2"	
302 11 0433 03	40	16"	
302 11 0434 03	40	16 1/2"	
302 11 0435 03	40	17"	
302 11 0436 03	40	17 1/2"	
302 11 0437 03	40	18"	
302 11 0438 03	40	18 1/2"	
302 11 0439 03	40	19"	
302 11 0440 03	40	19 1/2"	
302 11 0441 03	40	20"	
302 11 0442 03	40	20 1/2"	
302 11 0443 03	40	21"	
302 11 0444 03	40	21 1/2"	
302 11 0445 03	40	22"	
302 11 0446 03	40	22 1/2"	
302 11 0447 03	40	23"	
302 11 0448 03	40	23 1/2"	
302 11 0449 03	40	24"	
302 11 0450 03	40	24 1/2"	
302 11 0451 03	40	25"	
302 11 0452 03	40	25 1/2"	
302 11 0453 03	40	26"	
302 11 0454 03	40	26 1/2"	
302 11 0455 03	40	27"	
302 11 0456 03	40	27 1/2"	
302 11 0457 03	40	28"	
302 11 0458 03	40	28 1/2"	
302 11 0459 03	40	29"	
302 11 0460 03	40	29 1/2"	
302 11 0461 03	40	30"	
302 11 0462 03	40	30 1/2"	
302 11 0463 03	40	31"	
302 11 0464 03	40	31 1/2"	
302 11 0465 03	40	32"	
302 11 0466 03	40	32 1/2"	
302 11 0467 03	40	33"	
302 11 0468 03	40	33 1/2"	
302 11 0469 03	40	34"	
302 11 0470 03	40	34 1/2"	
302 11 0471 03	40	35"	
302 11 0472 03	40	35 1/2"	
302 11 0473 03	40	36"	
302 11 0474 03	40	36 1/2"	
302 11 0475 03	40	37"	
302 11 0476 03	40	37 1/2"	
302 11 0477 03	40	38"	
302 11 0478 03	40	38 1/2"	
302 11 0479 03	40	39"	
302 11 0480 03	40	39 1/2"	
302 11 0481 03	40	40"	
302 11 0482 03	40	40 1/2"	
302 11 0483 03	40	41"	
302 11 0484 03	40	41 1/2"	
302 11 0485 03	40	42"	
302 11 0486 03	40	42 1/2"	
302 11 0487 03	40	43"	
302 11 0488 03	40	43 1/2"	
302 11 0489 03	40	44"	
302 11 0490 03	40	44 1/2"	
302 11 0491 03	40	45"	
302 11 0492 03	40	45 1/2"	
302 11 0493 03	40	46"	
302 11 0494 03	40	46 1/2"	
302 11 0495 03	40	47"	
302 11 0496 03	40	47 1/2"	
302 11 0497 03	40	48"	
302 11 0498 03	40	48 1/2"	
302 11 0499 03	40	49"	
302 11 0500 03	40	49 1/2"	

**VALVED WALL BRACKET
FEMALE THREAD**

AIRpipe	DN	BSP	Ports
302 52 0102 03	20	1/2"	1 PORT 1/2"
302 52 0202 03	25	1/2"	1 PORT 1"
302 52 0204 03	25	1/2"	1 PORT 1/2"
302 52 0404 03	40	1/2"	1 PORT 1 1/4"
302 52 0505 03	50	1/2"	1 PORT 2"
302 52 0606 01	63	1/2"	1 PORT 2 1/4"
*Union connector Included			
AIRpipe	DN	BSP	Ports
302 52 0101 03	20	1/2"	2 PORTS 1/2"
302 52 0201 03	25	1/2"	2 PORTS 1/2"
*Union connector Included			
AIRpipe	DN	BSP	Ports
302 52 0105 03	20	1/2"	2 PORTS 1/4", 75°
302 52 0205 03	25	1/2"	2 PORTS 1/4", 75°
*Union connector Included			

BRASS BALL

**SWING CHECK
VALVE**

AIRpipe	BSP	DN	Type
302 80 0400 02	40	Cast iron	
302 80 0500 02	50	Cast iron	
*Union connectors Included			
302 80 0600 01	63	Cast iron	
302 80 0700 01	80	Cast iron	
302 80 0800 01	100	Cast iron	
302 80 1000 01	150	Cast iron	
302 80 1100 01	200	Cast iron	
*Use two union connectors			
AIRpipe	BSP	DN	Type
302 80 0401 02	40	Stainless steel	
302 80 0501 02	50	Stainless steel	
*Union connectors included			
302 80 0601 01	63	Stainless steel	
302 80 0701 01	80	Stainless steel	
302 80 0801 01	100	Stainless steel	
302 80 1001 01	150	Stainless steel	
302 80 1101 01	200	Stainless steel	
*Use two union connectors			

BUTTERFLY VALVE

FLANGE

All flanges contain bolts and flange gasket

AIRpipe	BSP	DN	Size
302 70 0600 01	63	65	
302 70 0700 01	80	80	
302 70 0800 01	100	100	
302 70 1000 01	150	150	
302 70 1100 01	200	200	

**FLANGE(CAST IRON)
FEMALE T-THREAD**

All flanges contain bolts and flange gasket

AIRpipe	BSP	DN	Size
302 79 0202 01	25	1"	
302 79 0404 01	40	1 1/4"	
302 79 0505 01	50	2"	
302 79 0602 01	65	1"	
302 79 0604 01	65	1 1/4"	
302 79 0805 01	65	2"	
302 79 0702 01	80	1"	
302 79 0704 01	80	1 1/4"	
302 79 0706 01	80	1 1/2"	
302 79 0708 01	80	1 3/4"	
302 79 0710 01	80	2"	
302 79 0712 01	80	2 1/4"	
302 79 0714 01	80	2 1/2"	
302 79 0716 01	80	2 3/4"	
302 79 0718 01	80	3"	
302 79 0720 01	80	3 1/4"	
302 79 0722 01	80	3 1/2"	
302 79 0724 01	80	3 3/4"	
302 79 0726 01	80	4"	
302 79 0728 01	80	4 1/4"	
302 79 0730 01	80	4 1/2"	
302 79 0732 01	80	4 3/4"	
302 79 0734 01	80	5"	
302 79 0736 01	80	5 1/4"	
302 79 0738 01	80	5 1/2"	
302 79 0740 01	80	5 3/4"	
302 79 0742 01	80	6"	
302 79 0744 01	80	6 1/4"	
302 79 0746 01	80	6 1/2"	
302 79 0748 01	80	6 3/4"	
302 79 0750 01	80	7"	
302 79 0752 01	80	7 1/4"	
302 79 0754 01	80	7 1/2"	
302 79 0756 01	80	7 3/4"	
302 79 0758 01	80	8"	
302 79 0760 01	80	8 1/4"	
302 79 0762 01	80	8 1/2"	
302 79 0764 01	80	8 3/4"	
302 79 0766 01	80	9"	
302 79 0768 01	80	9 1/4"	
302 79 0770 01	80	9 1/2"	
302 79 0772 01	80	9 3/4"	
302 79 0774 01	80	10"	
302 79 0776 01	80	10 1/4"	
302 79 0778 01	80	10 1/2"	
302 79 0780 01	80	10 3/4"	
302 79 0782 01	80	11"	
302 79 0784 01	80	11 1/4"	
302 79 0786 01	80	11 1/2"	
302 79 0788 01	80	11 3/4"	
302 79 0790 01	80	12"	
302 79 0792 01	80	12 1/4"	
302 79 0794 01	80	12 1/2"	
302 79 0796 01	80	12 3/4"	
302 79 0798 01	80	13"	
302 79 0800 01	80	13 1/4"	
302 79 0802 01	80	13 1/2"	
302 79 0804 01	80	13 3/4"	
302 79 0806 01	80	14"	
302 79 0808 01	80	14 1/4"	
302 79 0810 01	80	14 1/2"	
302 79 0812 01	80	14 3/4"	
302 79 0814 01	80	15"	
302 79 0816 01	80	15 1/4"	
302 79 0818 01	80	15 1/2"	
302 79 0820 01	80	15 3/4"	
302 79 0822 01	80	16"	
302 79 0824 01	80	16 1/4"	
302 79 0826 01	80	16 1/2"	
302 79 0828 01	80	16 3/4"	
302 79 0830 01	80	17"	
302 79 0832 01	80	17 1/4"	
302 79 0834 01	80	17 1/2"	
302 79 0836 01	80	17 3/4"	
302 79 0838 01	80	18"	
302 79 0840 01	80	18 1/4"	
302 79 0842 01	80	18 1/2"	
302 79 0844 01	80	18 3/4"	
302 79 0846 01	80	19"	
302 79 0848 01	80	19 1/4"	
302 79 0850 01	80	19 1/2"	
302 79 0852 01	80	19 3/4"	
302 79 0854 01	80	20"	
302 79 0856 01	80	20 1/4"	
302 79 0858 01	80	20 1/2"	
302 79 0860 01	80	20 3/4"	</

FIXTURE CLAMPS & ACCESSORIES





CLAMP SPACER



VORTEX FLOW METER



THREADED ADAPTORS





PRESSURE METER



ATMOLYSIS BAG



SAMPLE BOX



TOOL BOX



DRILL (TAPPER)



DRILL HOLDER



MARKER

HOLE DEBURRER

ALUMINUM PIPE DEBURRER



SPANNERS



ALUMINUM PIPE CUTTER



ELECTRIC PIPE CUTTER



FIXING BOLT

SQUARE STEEL



ADJUSTABLE BRACKET



GRIDER CLAMP



SQUARE STEEL CLAMP



PIPE BENDING TOOL



MS STEEL SELF TAP SCREWS

WALL MOUNTED BRACKET



UNIVERSAL BEAM SUSPENDER



FIXTURE CLAMPS & ACCESSORIES

WIRE SUSPENSION CABLE



LUGGING MACHINE



Superior Reliability!



Insertion Depth S For DN20-DN50 Connector

DN	Insertion depth S (mm)
50	29

Installation Guide for DN20-DN50

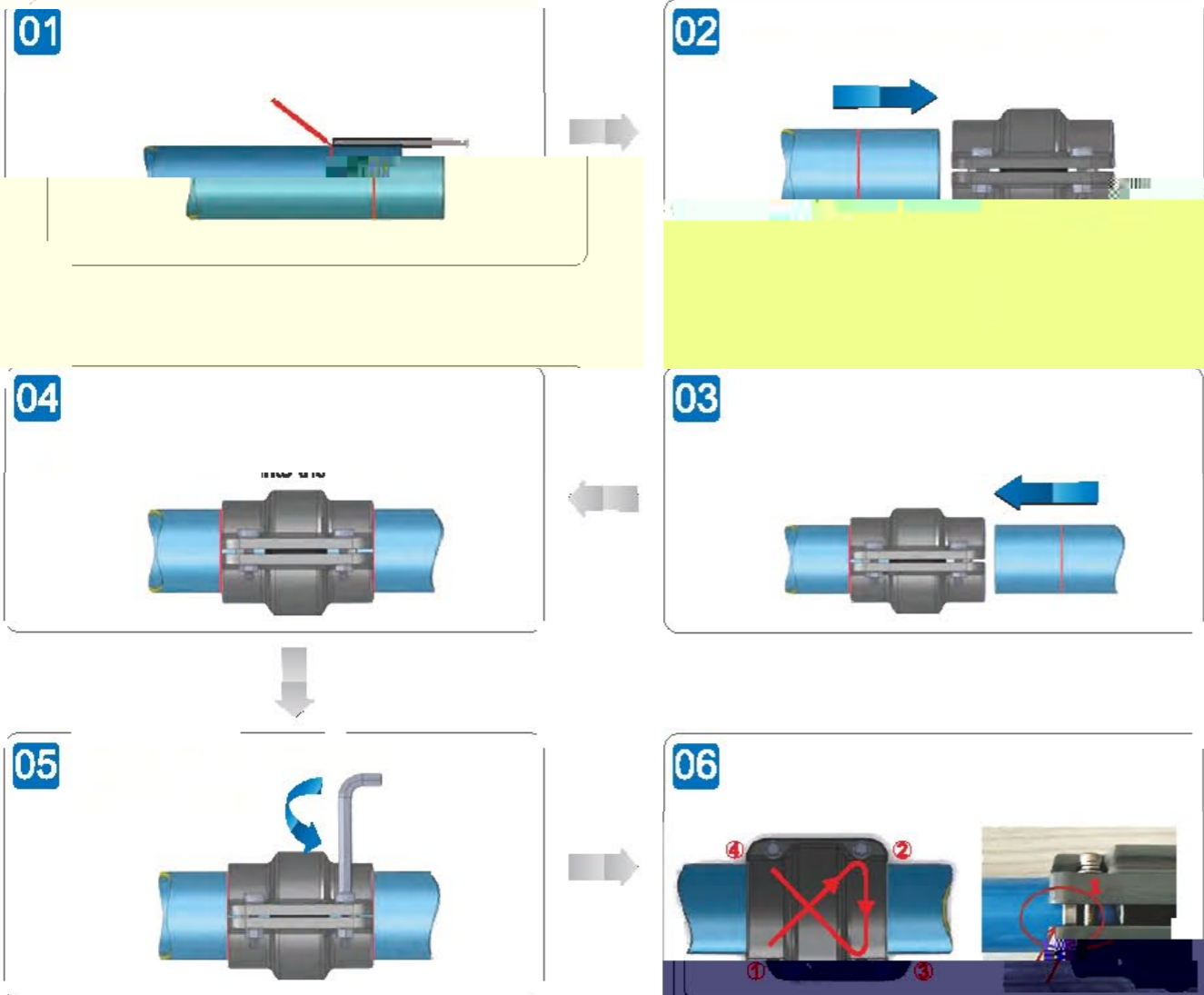

Deburr & Chamfer The Outer and Inner Edges Before Installation

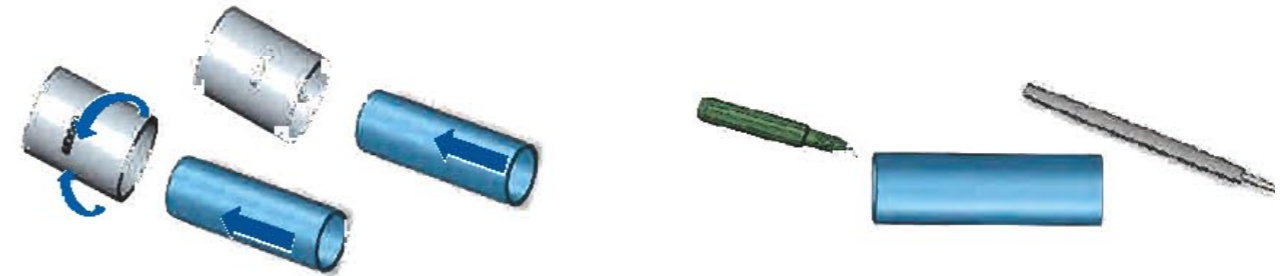

Installation Guide for DN63-DN200

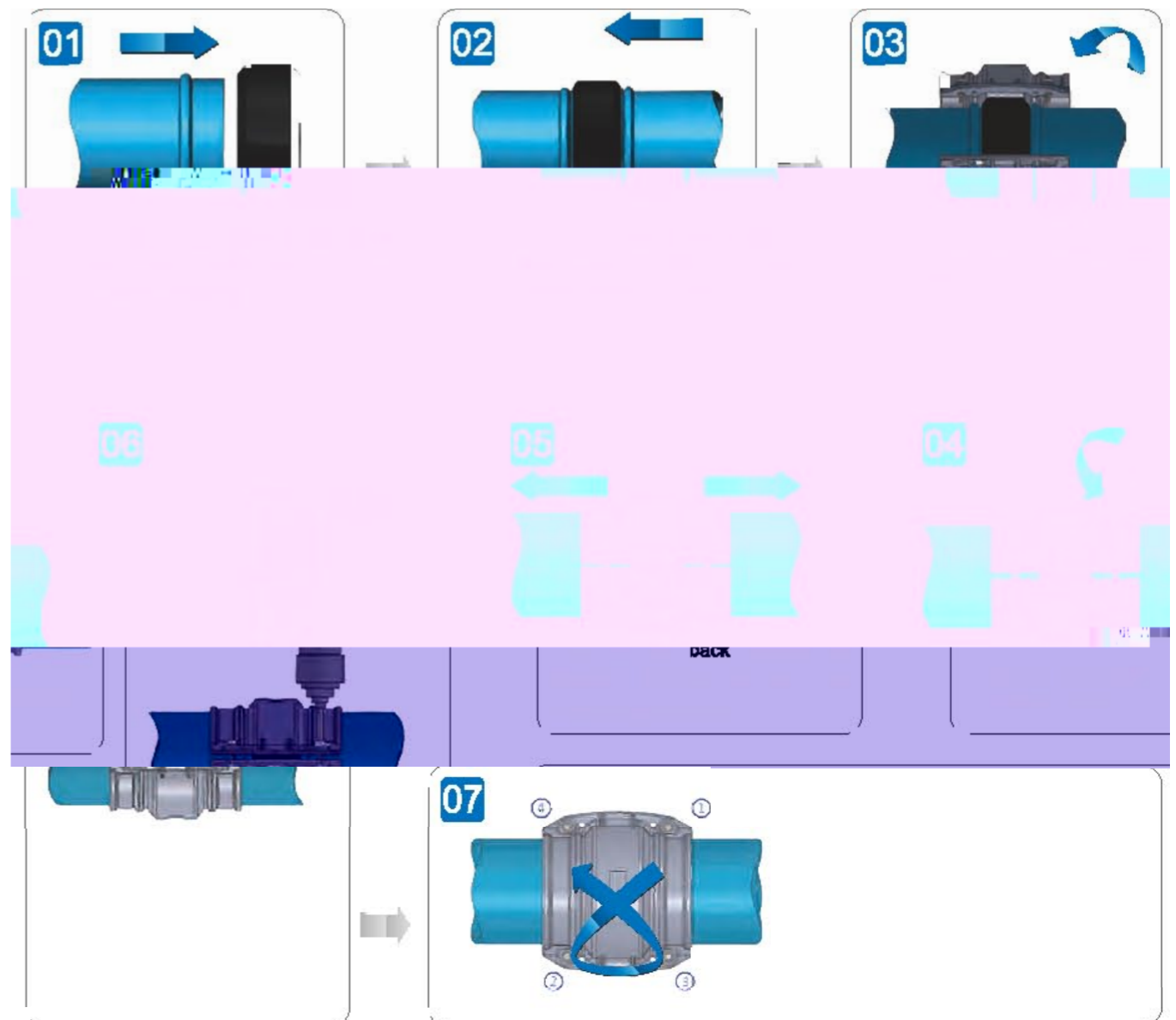

Hand-held hydraulic lugging machine operation requirements



Manually open the jaws of the clamp and insert the aluminum pipe into the clamp as far as possible.

Release the jaws. Press the trigger and crimp the pipe until a "snap" sound is heard.

Re-open the two jaws to remove the pipe and rotate the pipe slightly. Put the jaw side to the mark position.

Renew the operation until the required minimum number of lugs for each diameter is finished.

Number of lugs for each diameter:

AIRPIPE	DN63	DN80	DN100	DN150	DN200
	5	6	6	6	2

Note: Do not overlap the lugs!

DN	H(mm)
63	3.0-3.3
80	3.0-3.3
100	3.0-3.3
150	3.0-3.3
200	3.0-3.3



Sizing Chart for Quick Drops

Drill	Drill Holder	DN(MM)	Quick Drops (PN)
301 35 0005 01	301 35 0008 08	φ16	302 10 0201 04 302 10 0202 03 302 11 0200 03 302 11 0401 03
301 35 0005 01	301 35 0008 07	φ22	302 10 0401 04 302 10 0402 04 302 11 0400 03 302 10 0602 01 302 10 0701 01 302 10 0702 01
			302 10 0801 01 302 10 0802 01 302 10 0801 01 302 10 1002 01 302 10 1102 01
301 35 0005 01	301 35 0008 03	φ26	302 10 0801 01 302 10 0802 01 302 10 1001 01 302 11 0301 01 302 11 0700 01 302 11 0701 01
			302 11 0500 01 302 11 0501 01 302 11 0900 01
			302 11 0800 01 302 11 1000 01
301 35 0005 02	301 35 0008 04	φ38	302 10 0804 01
301 35 0005 02	301 35 0008 05	φ51	302 10 1004 01 302 10 1006 01 302 10 1104 01 302 10 1105 01

- The following table is based on a closed-loop pipe system.
- Working pressure is 8bar and pressure drop is 0.4bar, flow speed not taken into account.

Flow N m ³ /h	Length										
	50M	100M	150M	300M	500M	750M	1000M	1300M	1600M	2000M	
10	20	20	20	20	20	20	20	25	25	25	
30	20	20	20	25	25	25	25	25	25	40	
50	20	25	25	25	25	25	25	40	40	40	
70	25	25	25	25	40	40	40	40	40	40	
100	25	25	25	40	40	40	40	40	40	50	
150	25	40	40	40	40	40	40	60	50	50	
250	40	40	40	40	50	50	50	50	50	50	
350	40	40	40	50	50	50	50	50	50	50	
500	40	40	50	50	50	50	50	50	50	50	
750	40	50	50	50	50	50	50	50	50	50	
1000	50	50	50	50	50	50	50	50	50	50	
1250	50	50	50	50	50	50	50	50	50	50	
1500	50	50	50	50	50	50	50	50	50	50	
1750	50	50	50	50	50	50	50	50	50	50	
2000	50	50	50	50	50	50	50	50	50	50	
2500	50	50	50	50	50	50	50	50	50	50	
3000	50	50	50	50	50	50	50	50	50	50	
3500	50	50	50	50	50	50	50	50	50	50	
4000	50	50	50	50	50	50	50	50	50	50	
4500	50	50	50	50	50	50	50	50	50	50	
5000	50	50	50	50	50	50	50	50	50	50	
5500	50	50	50	50	50	50	50	50	50	50	
6000	50	50	50	50	50	50	50	50	50	50	
6500	50	50	50	50	50	50	50	50	50	50	
7000	50	50	50	50	50	50	50	50	50	50	
7500	50	50	50	50	50	50	50	50	50	50	
8000	50	50	50	50	50	50	50	50	50	50	
8500	50	50	50	50	50	50	50	50	50	50	
9000	50	50	50	50	50	50	50	50	50	50	
9500	50	50	50	50	50	50	50	50	50	50	
10000	50	50	50	50	50	50	50	50	50	50	
10500	50	50	50	50	50	50	50	50	50	50	
11000	50	50	50	50	50	50	50	50	50	50	
11500	50	50	50	50	50	50	50	50	50	50	
12000	50	50	50	50	50	50	50	50	50	50	

Technical Specifications

- Max. working pressure: 15bar (-20°C ~ +80°C), 16bar (-20°C ~ +45°C)
Max. working pressure for DN200 is 13bar.
- Vacuum: 1mbar (absolute pressure).
- Working temperature: -20°C ~ +80°C.
- Suitable fluids: compressed air, oil-free or lubricated, wet, vacuum, inert gases.
- Fireproof and suitable for outdoor applications.

Qualification & Standards

2014/68/EU, ASME B31.1, TUV, GB/T4437.1-2000, EN755-8, TS, U694, ISO 8573-1



Engineered for superior performance

- We are committed to provide superior products and service.
- R&D is a continuous process linked to real-world conditions & market feedback.
- Always customer oriented, from design production to sales and service.

we are at your SERVICE

